

EN LED spotlight with
motion detector

theLeda E10 WH 1020911
theLeda E10 BK 1020912
theLeda E20 WH 1020913
theLeda E20 BK 1020914



1. Basic safety information	3
Proper use	3
Disposal	3
2. Description	4
3. Connection	4
4. Installation	6
Installation instructions	9
5. Walking test	10
6. Alignment	11
Limiting the detection area - using stickers	11

7. Setting	12
Setting the brightness (lux)	12
Setting the time (min.)	13
Manual operation	13
Setting the twilight switch function	14
8. Technical data	15
9. Contact	16



1. Basic safety information



WARNING

Danger of death through electric shock or fire!

- Installation should only be carried out by a qualified electrician!

- The LED spotlight with motion detector (PIR) conforms to EN 60598-1 if correctly installed
- Only intended for installation outside of arm's reach

Proper use

- LED spotlight is used for lighting, depending on presence and brightness
- Intended for wall mounting outdoors
- Suitable for corridors, gardens, entrances, parks etc.
- For use in normal ambient conditions

Disposal

Dispose of LED spotlight in an environmentally sound manner (electronic waste)

2. Description

LED spotlight

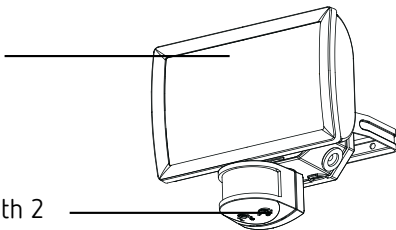

Sensor head with 2 potentiometers for setting time (min.) and brightness (lux)

3. Connection



WARNING

Danger of death through electric shock!

- Disconnect power source
- Ensure device cannot be switched on
- Check absence of voltage
- Earth and bypass
- Cover or shield any adjacent live components

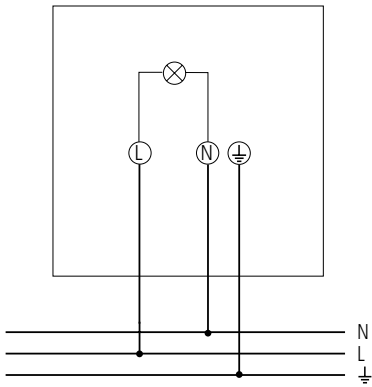

- Do not touch the metal parts. The device can get hot.

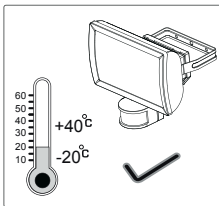

4. Installation

- Ensure installation height of 2.5 m.

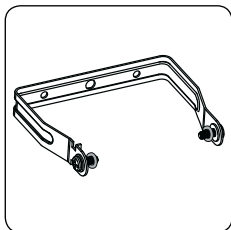

- Use the accompanying mounting bar for flexible installation and cable entry.

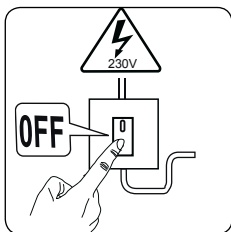

- Disconnect power source.

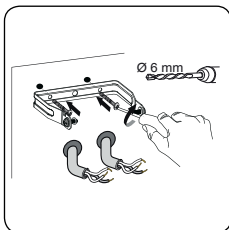
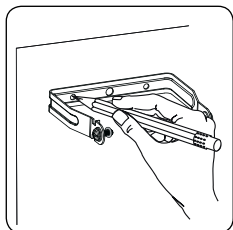

- ▶ Make marks for the holes and drill the holes.
- ▶ Tighten the mounting bar.

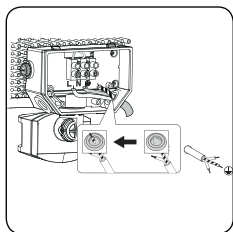

- ▶ Feed cable through the seal of the base.

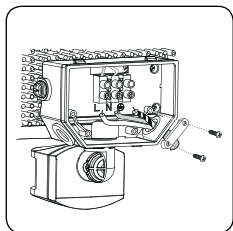

- ▶ Fix cord grip and tighten screws.



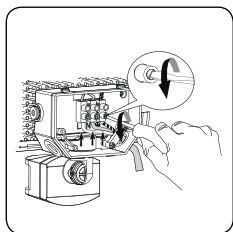

- Connect the individual wires to the appropriate terminal.

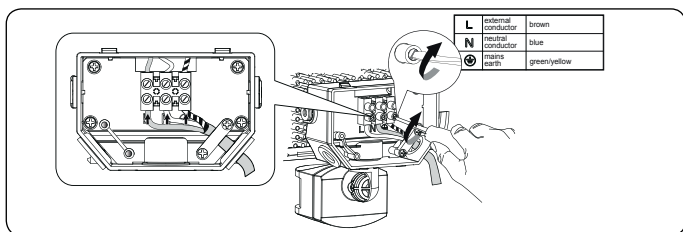

- Tighten screws.

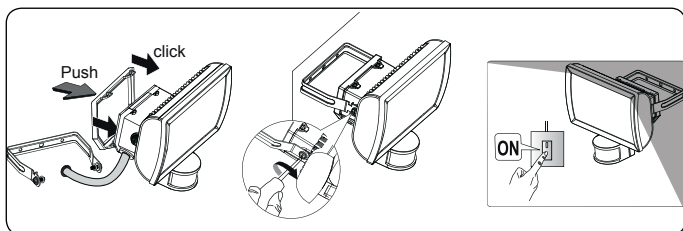

- Place and engage the cover on the LED spotlight.
- Place the LED spotlight on the mounting bar and tighten screws.
- Connect LED spotlight to mains.

Installation instructions

As the LED spotlight reacts to variations in temperature, avoid the following situations:

- Do not direct motion detectors (PIR) of the LED spotlight at objects with highly-reflective surfaces, such as mirrors etc.
- Do not install motion detectors near heat sources, such as heating outlets, air conditioning systems, lamps etc.
- Do not direct the motion detector at objects that move in the wind, such as curtains, large plants etc.
- Pay attention to the direction of motion during the test run.

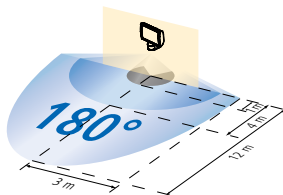
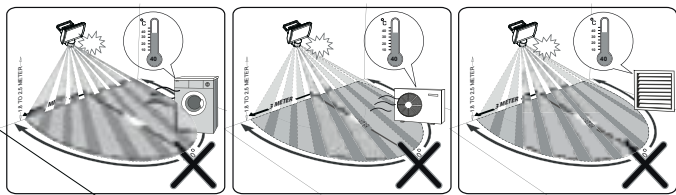

- Transverse detection area: 12 m (transversal to the detector)
- Frontal detection area: 4 m (directly approaching the detector)
- Detection angle: 180 °

5. Walking test

The walking test is used to test the detection area and to restrict it if necessary.

- ▶ Turn the time potentiometer (min.) counterclockwise up to the stop.

The motion detector now only reacts to movements (independent of brightness).

- ▶ Walk across the detection area. After the LED spotlight has detected a movement, it switches on for 2 s.
- ▶ Pay attention to the direction of motion during the test.

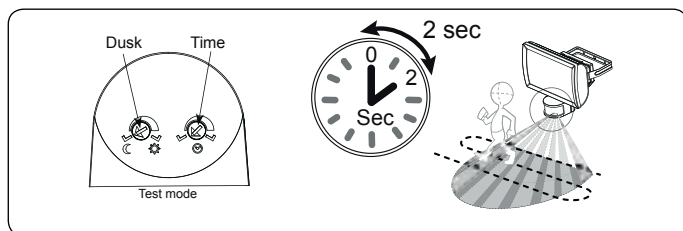

6. Alignment

- The sensor can be rotated to left/right and down by 90 °.
- The LED spotlight can be rotated up by 45 ° and down by 60 °.

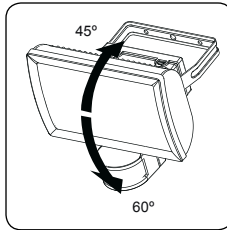
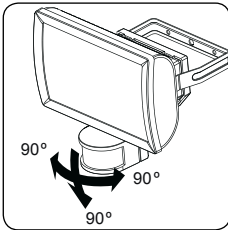

Limiting the detection area - using stickers

- Use the supplied stickers to adjust the motion detector to the desired detection area.
- Remove the required section of the sticker by using scissors.
- Then place on the lens.

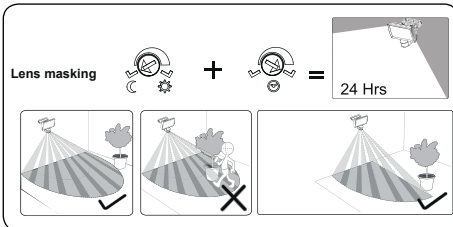

7. Setting

The LED spotlight has 2 potentiometers for setting time (min.) and brightness (lux).

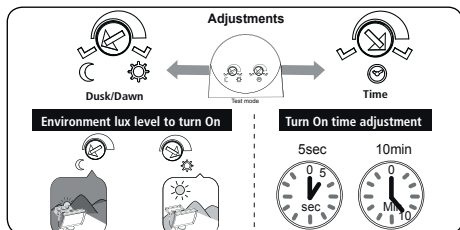

Setting the brightness (lux)

- ▶ Turn the potentiometer to „Moon“; the LED spotlight only switches on when it is relatively dark.



- ▶ Turn the potentiometer to „Sun“; the LED spotlight switches on when it is relatively bright.



- ▶ Turn the potentiometer to „Sun“, and the device works independent of brightness.



Setting the time (min.)

- ▶ Set the potentiometer to the desired time (5 s - 10 min.).



Manual operation

The lighting can be manually switched on/off via a circuit breaker button.

- ❶ The surrounding brightness must be below the set value!
- ❷ A circuit breaker button must be connected.

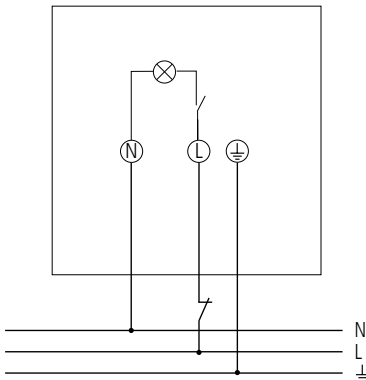

- ▶ Shortly press the circuit breaker button (max. 1.5 seconds)

- The lighting remains switched on, until the surrounding brightness exceeds the set value.
- ▶ In order to switch off the lighting, shortly press the circuit breaker button (max. 1.5 seconds).

Setting the twilight switch function

- ▶ Turn the time potentiometer (min.) clockwise up to the stop.
 - The twilight switch function is activated.
- ① Now, the motion detector does not respond to movements anymore.
- ① The connected spotlight switches on at the set surrounding brightness

⚠ CAUTION!

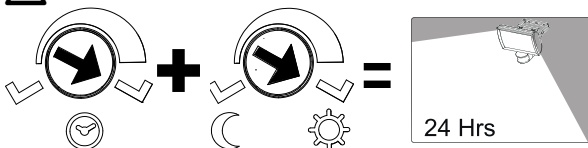

8. Technical data

- Operating voltage: 230 V AC $\pm 10\%$
- Frequency: 50–60 Hz
- Consumption with light ON:
 - theLeda E10: 10.3 W
 - theLeda E20: 17.7 W
- Standby output: max. 0.5 W
- LED output (luminous flux):
 - theLeda E10 WH: 750 lm
 - theLeda E10 BK: 685 lm
 - theLeda E20 WH: 1325 lm
 - theLeda E20 BK: 1260 lm
- Lamp type: LED 10 W, 20 W
(not dimmable)
- Protection rating: IP 55 in accordance with EN 60598-1
- Protection class: I in accordance with EN 60598-1
- Operating temperature: $-20\text{ }^{\circ}\text{C} \dots +40\text{ }^{\circ}\text{C}$
- Brightness setting range: 2 – 200 lx
- Duty cycle range: 5 s – 10 min
- Detection angle: 180°
- Detection area: transverse: max. 12 m;
frontal: max. 4 m
- Installation height: 2.5 m
- Sensor head can be rotated right/left, down by: $90^{\circ}, 90^{\circ}$
- Spotlight can be rotated up by: 45° and down by: 60°
- Energy efficiency class: A+



9. Contact

Theben AG

Hohenbergstraße 32

72401 Haigerloch

GERMANY

Phone: +49 7474 692-0

Fax: +49 7474 692-150

Hotline

Phone: +49 7474 692-369

hotline@theben.de

www.theben.de

